

# IMPRESSA Xs9 Classic

## Détartrage de la machine

Durée prévue 45 min

Matériel nécessaire:

Tablettes de détartrage

Boîte de 36 unités (Art. 70751)

Paquet de 3 unités (Art. 61848)



Ce mode d'emploi abrégé ne remplace pas le « Mode d'emploi IMPRESSA Xs9 Classic ». Tout d'abord, veuillez lire et respecter impérativement les consignes de sécurité et mise en garde afin d'éviter tous dangers.

Condition : CHOISIR PRODUIT /  
DÉTARTRE APPAREIL



DUREE ENV. 45 MIN /  
ALLUMER OUI



VIDER CUVE

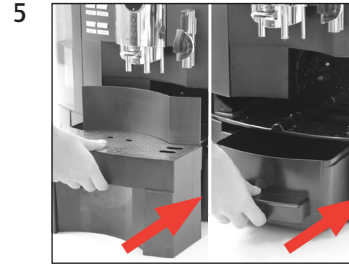
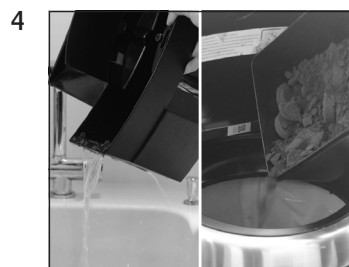
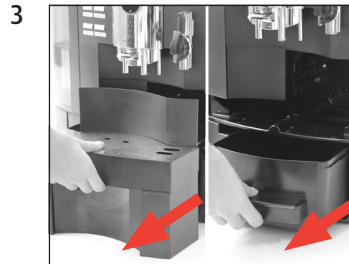

AJOUTER PRODUIT

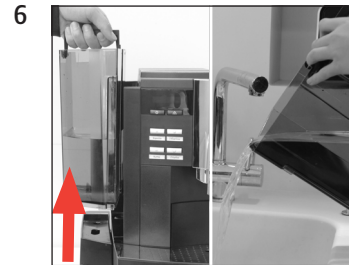

AJOUTER PRODUIT /  
PRESSER ENTRETIEN

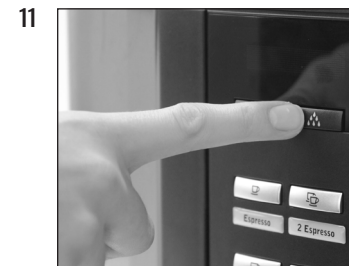

DÉTARTRE  
VIDER CUVE

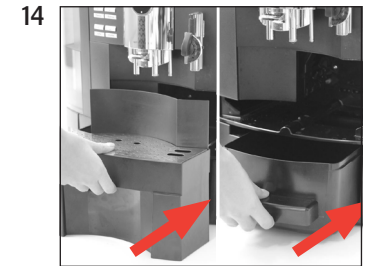
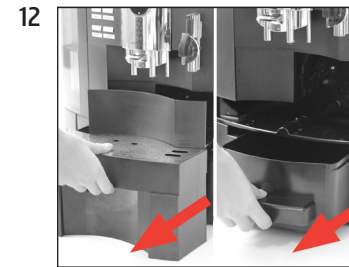

RINER RESERVOIR /  
REPLIR RESERVOIR

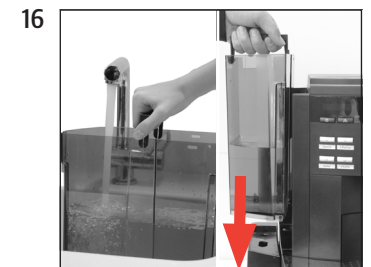
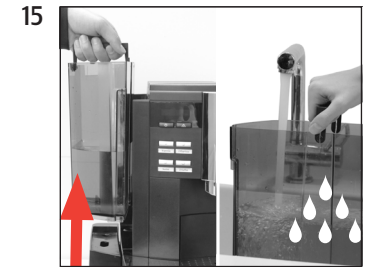

PRESSER ENTRETIEN

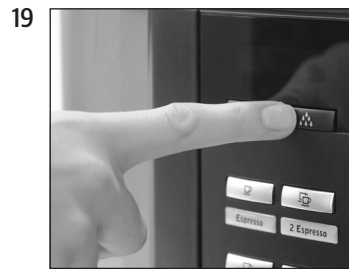
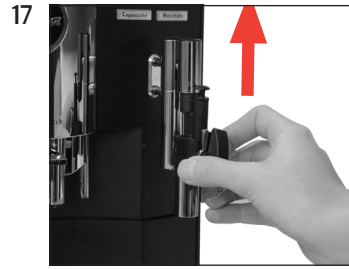

DETARTRE  
APPAR. CHAUFFE  
APPAR. RINCE  
VIDER CUVE

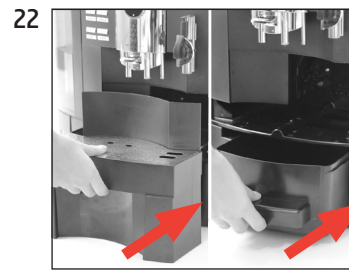
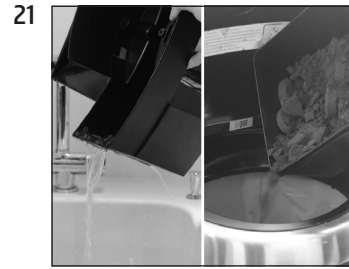
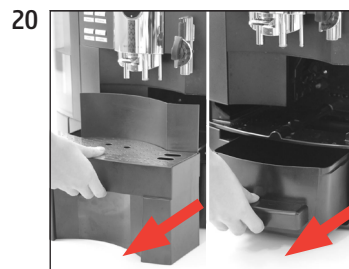

CHOISIR PRODUIT